



QRD1000IFACE3 (LFH - LFQR - LFT)

Stand-alone access and presence control terminal.

Qualica-RD IFACE3 (LFH-LFQR-LFT). Metal device for outdoor use. Water and dust resistant (IP65). Operates at temperatures from -5°C to 45°C. LED light with adjustable brightness. Integrated web server for system configuration.

Optional card modules: 12.5 KHz card / 13.56 MHz card. Supports up to 500 faces / 3,000 fingerprints / 3,000 RFID cards / 200,000 records. Support for IEEE 802.3af/at power over TCP/IP communication.

- The **LHF** model features several verification methods, including RFID cards, facial recognition and fingerprint verification.
- The **LFQR** model features a QR code reader module, and supports facial recognition and RFID cards. This product series is also equipped with the latest anti-piracy algorithm to guarantee security.
- The **LFT** model supports HD video door entry via a mobile application (consult your sales representative).



QRD1000IFACE3 (LFH-LFQR-LFT)

Technical specifications

Product model	QRD1000IFACE3-LFH	QRD1000IFACE3-LFQR	QRD1000IFACE3-LFT
Monitor	2.4" touch screen	2.4" touch screen	2.4" touch screen
Biometric	Face / Imprint	Face only	/
QR code	/	QR code, bar code PDF417 (optional), Data matrix (optional), Micro PDF417 (optional), Azteca (Optional)	/
RFID	125 KHz card (optional), 13.56 Mhz card (optional)	125 KHz card (optional), 13.56 Mhz card (optional)	125 KHz card, 13.56 Mhz card (optional)
User capacity	3,000	3,000	3,000
Card capacity	3,000	3,000	3,000
Face capacity	500	500	/
Overall dimensions	3,000	/	/
Registration capacity	200,000	200,000	200,000
Facial recognition algorithm	Qualica-RD 3.5		
Facial recognition speed	<1s		
Facial recognition distance	0.5m to 2m		
Communication	TCP/IP, WiFi (optional), Wiegand input/output, RS485, Bluetooth (optional)		
Operating system	Linux		
Standard functions	ADMS, DST, Camera, 14-digit user ID, Access levels, Groups, Holidays, Anti-passback, Log interrogation, tamper switch alarm, log interrogation		
Hardware	Dual Core 1.2GHz CPU, 256MB RAM/512MB FLASH, 1MP Binocular camera, adjustable LED light		
Access control interface	Electric lock, door sensor, exit button, alarm output, auxiliary input		
Power supply	12V 3A	12V 3A	12V 3A
Protection level	IP65	IP65	IP65
Working temperature	-5°C to 45°C	-5°C to 45°C	-5°C to 45°C
Operating humidity	10% to 90% RH	10% to 90% RH	10% to 90% RH
Dimensions (W*H*D)	185*58.5*20mm	185*58.5*20mm	185*58.5*20mm
Supported software/APP	Consult your sales representative		

Configuration (mm)

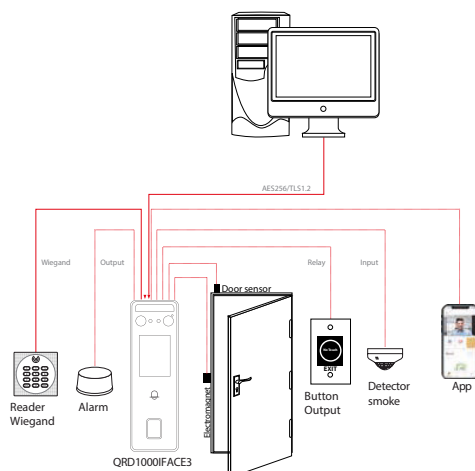

Dimensions (mm)

